

325 clicket

S358



CATALOGO PARTI DI RICAMBIO
E ISTRUZIONI D'USO

SPARE PARTS CATALOGUE AND
INSTRUCTIONS FOR THE USE

CATALOGUE PIECES DE RECHANGE
ET INSTRUCTIONS POUR LE
FONCTIONNEMENT

CATALOGO PIEZAS DE REPUESTO
E INSTRUCCIONES PARA EL USO

N°

S 358

INSTRUCTIONS FOR THE USE OF THE S358

PLEASE READ CAREFULLY: IT IS VERY IMPORTANT

ATTENTION:

Before connecting up the machine, it is necessary to:

- 1) fit the shock-absorbers to the machine feet.
- 2) remove the back filter (2) and the beam constraint bracket (as shown at table n. 10) utilized for the machine transport.
- 3) fill the tank with 120 Kilos of special quality hydraulic oil of high viscosity index (3,5° - 4° Engler at 50° C. / 122° F) (We recommend you to use ISO 46 type) (The right oil level is at 150 mm. approx from the tank bottom).

CONNECTING UP AND SETTING-UP OF THE MACHINE

Before connecting up the machine, ensure that the factory voltage corresponds with that of the machine which is shown on the plate (V) (see table n. 1). If, for any reason, the voltage should be changed, it is imperative that the voltage to the transformer of the electrical equipment is also changed.

The pump is working in the right direction when the motor - switched on by the main switch (O) and operated by the black pushbutton (I) - turns in the direction of the arrow outside the motor.

If it does not, change the polarity of the connections.

In order to exhaust all the air in the pipes and cylinders, act as follows:

- 1) place the pressure adjuster (F) on the minimum value, by turning it anticlockwise.
- 2) place the daylight adjuster (E) at the middle of its value approx.
- 3) operate the machine by laying both hands on the hand contact controls (Q) and (R) - simultaneously - (for safety purposes the controls present a built-in device for 3/10 of second maximum delay operation).

Repeat this operation for a few minutes.

At this point the machine is ready for working.

CUTTING WITH AUTOMATIC STROKE END SETTING-UP (PRESSURE SWITCH)

To adjust the cutting with automatic stroke end setting-up, act as follows:

- 1) turn the pressure adjuster (F) to the minimum value.
- 2) bring the selector handle (U) to position 0-zero
- 3) the cutting table completely free, get the beam down onto the cutting board by operating the hand contact controls (Q) and (R) simultaneously.
- 4) bring the selector handle (U) to position 1 and the beam will move upwards automatically.
- 5) operate the adjuster (E) to obtain the wanted daylight.

6) operate the pressure adjuster (F) to obtain the right cutting precision according to the linear development of the cutting-knife and to the thickness of the material to cut.

At this point the machine is ready for working with any cutting-knife of whatever height.

CUTTING WITH TRADITIONAL STROKE END SETTING-UP

To adjust the cutting with traditional stroke end, act as follows:

- 1) turn the pressure adjuster (F) to the minimum value.
- 2) bring the selector handle (U) to position 0-zero.
- 3) place the cutting-knife on the cutting table of the machine, without any material to cut.
- 4) get the beam down onto the cutting-knife by operating the hand contact controls (Q) and (R) simultaneously.
- 5) bring the selector handle (U) to position 2 and the beam will move upwards automatically.
- 6) operate the adjuster (E) to obtain the wanted daylight.
- 7) operate the pressure adjuster (F) to obtain the right cutting precision according to the linear development of the cutting-knife.

At this point the machine is ready for working with any cutting-knife of the same height as the one employed to adjust the machine.

Whenever you change the height of the cutting-knife, you must readjust the machine as above described.

PHOTOCELLS PROTECTION BARRIER

The photocells protection barrier with manual restoration (A) performs during the whole descent of the beam.

During this operation, whenever the photocells protection barrier is crossed by the hands of the operator or any other interference, it stops the descent of the beam.

HOW TO OPERATE THE AUTOMATIC FEEDER

By turning the switch (H) to the right, the upper roller of the automatic feeder lifts up, by turning it to the left the roller lowers.

By turning the switch (G) to the right, the material is fed; by turning it to the left, the material moves back.

The material feeding can also be controlled by the foot-treadle (Z).

The switch (B) puts on and off the light.

The switch (C) inserts or excludes the cut-counting device (D).

The red pushbutton (L) stops the machine.

OTHER DEVICES

On the S 350 the cutting pressure variations can also be obtained by linking up the machine with either the 10-cutting-knife holder PF/10 or the scheduled cut-counting device for 5 cutting-knives G/5 or 10 cutting-knives G/10.

In fact, through the potentiometers inserted in these devices you can preset the most suitable cutting pressure for every single cutting-knife.

IMPORTANT

For a prompt supply of the spare parts we need to know:

- type and serial number of the machine.
- number of plate in the catalogue
- reference number of the spare part
- required quantity.

For example:

No. 2 pieces - part No. 1.2552 plate 5 for machine S 358 Serial No....

No. 1 piece - part No. 2.1356 plate 2 for machine S 358 Serial No....

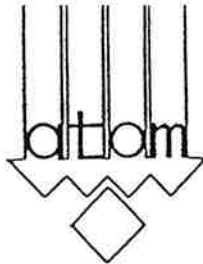

Lib. 477-6153

NOMENCLATURA COMANDI ED UTILIZZATORI

- A - BARRIERA FOTOELETTRICA
- B - INTERRUTTORE PER LAMPADA DI ILLUMINAZIONE
- C - INTERRUTTORE PER ESCLUSIONE CONTEGGIO
- D - CONTACOLPI A PROGRAMMA
- E - REGOLATORE DI APERTURA PONTE
- F - REGOLATORE DI PRESSIONE
- G - INTERRUTTORE A DUE POSIZIONI PER AVANZAMENTO ED ARRETRAMENTO MATERIALE ALIMENTATORE
- H - INTERRUTTORE DI APERTURA E CHIUSURA RULLI
- I - PULSANTE NERO DI MARCIA
- L - PULSANTE ROSSO D'ARRESTO
- M - SPIA VERDE DI ALIMENTAZIONE CORRENTE
- N - SPIA BOSSA DI MARCIA MOTORE
- O - INTERRUTTORE GENERALE
- P - LAMPADA DI ILLUMINAZIONE
- Q - SENSIBILE DI COMANDO LATERALE
- R - SENSIBILE DI COMANDO CENTRALE
- S - CONVOGLIATORE DI SFRIDO
- T - MARSUPIO
- U - MANIGLIA DI SELEZIONE FINE CORSA
- V - TARGHETTA PORTA MATRICOLA E VOLTAGGIO
- Z - COMANDO A PEDALE PER AVANZAMENTO MATERIALE,

Numero di matricola
macchina
Numéro de série
machine
Machine serial
number
Numero de matricola
maquina
Maschinennummer

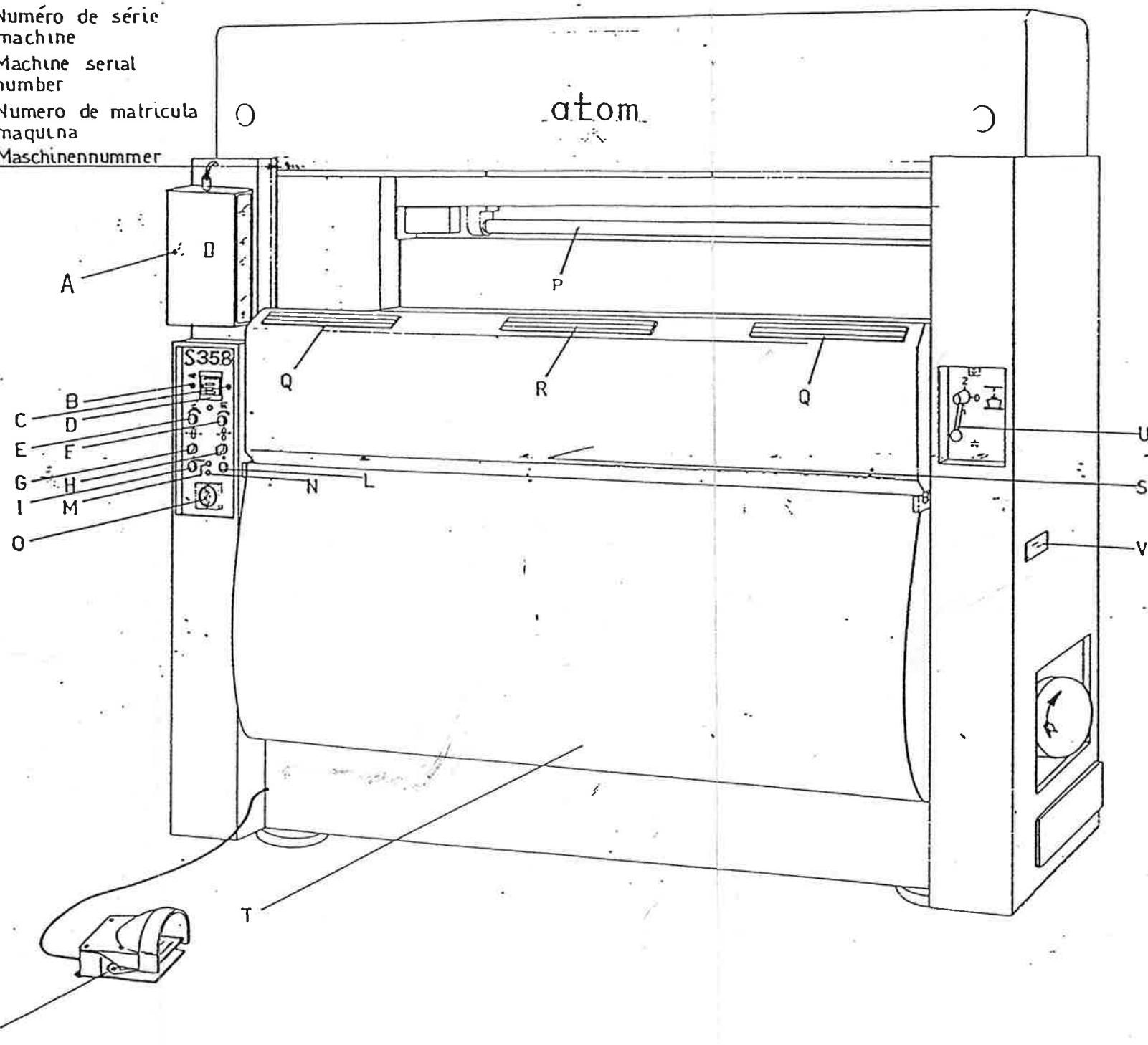

NOMENCLATURE

- A - BARRIERE PHOTOELECTRIQUE
- B - INTERRUPTEUR POUR LAMPE D'ECLAIRAGE
- C - INTERRUPTEUR POUR EXCLUSION COMPTAGE
- D - COMPTE-COUPS A PROGRAMMER
- E - REGULATEUR D'OUVERTURE PONT
- F - REGULATEUR DE PRESSION
- G - INTERRUPTEUR A DEUX VOIES POUR AVANCEMENT ET RECU MATERIEL ALIMENTATEUR
- H - INTERRUPTEUR A DEUX VOIES POUR OUVERTURE ET FERMETURE ROULEAUX
- I - POUSSOIR NOIR DE MISE EN MARCHE
- L - POUSSOIR ROUGE D'ARRET
- M - LAMPE TEMOIN VERT D'ALIMENTATION COURANT
- N - LAMPE TEMOIN ROUGE DE MARCHE MOTEUR
- O - INTERRUPTEUR GENERAL
- P - LAMPE D'ECLAIRAGE
- Q - CONTACT SENSIBLE LATERAL
- R - CONTACT SENSIBLE CENTRAL
- S + CONVOYEUR DE FREINTE
- T - MARSUPIUM
- U - POIGNEE DE SELECTION FIN COURSE
- V - PLAQUETTE PORTE-MATRICULE ET VOLTAGE
- Z - COMMANDE A PEDALE POUR AVANCEMENT MATERIEL

NOMENCLATURE

- A - PHOTOCELLS PROTECTION BARRIER
- B - NEON LAMP SWITCH
- C - CUT-COUNTING DEVICE SWITCH
- D - SCHEDULED CUT-COUNTING DEVICE
- E - DAYLIGHT ADJUSTER
- F - PRESSURE ADJUSTER
- G - 2-WAY SWITCH FOR FEEDING AND MOVING BACK THE MATERIAL IN THE FEEDER
- H - 2-WAY SWITCH FOR OPENING AND CLOSING THE FEEDER ROLLERS
- I - START BLACK PUSHBUTTON
- L - STOP RED PUSHBUTTON
- M - CURRENT FEEDING GREEN WARNING LIGHT
- N - RUNNING MOTOR RED WARNING LIGHT
- O - MAIN SWITCH
- P - NEON LAMP
- Q - SIDE HAND CONTACT CONTROL
- R - CENTRAL HAND CONTACT CONTROL
- S - SCRAP CONVEYOR
- T - MARSUPIUM
- U - STROKE END SELECTING HANDLE
- V - SERIAL NUMBER AND VOLTAGE PLATE
- Z - MATERIAL FEEDING FOOT TREADLE CONTROL

matricola — alla matricola
apertura tavola — data chiusura tavola

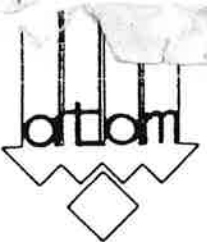

GRUPPO BASAMENTO
S 358

TAVOLA
2

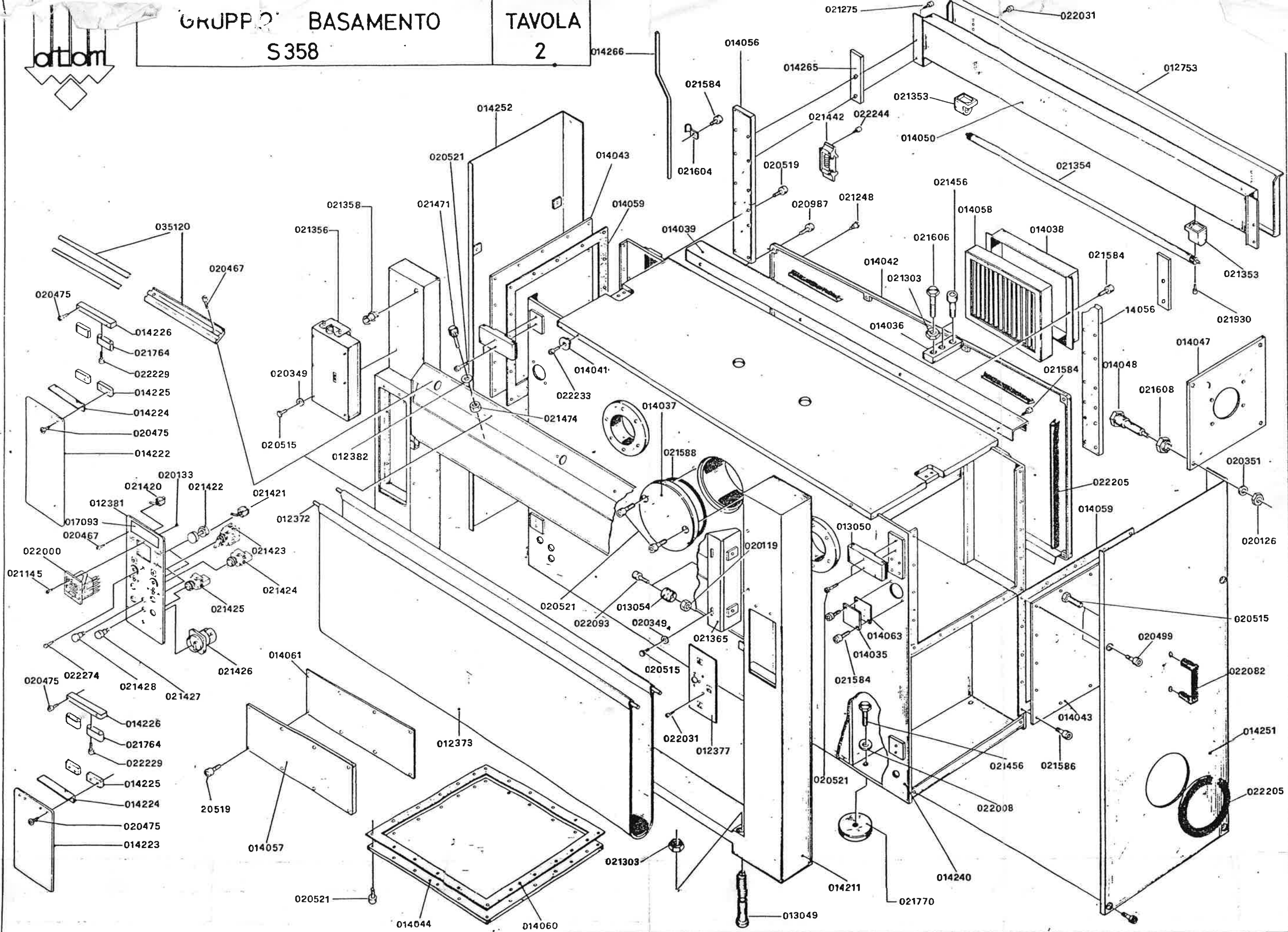

Dalla matricola alla matricola
Data apertura tavola data chiusura tavola



GRUPPO STRUTTURA E BIELLIS. TAVOLA
S358 3

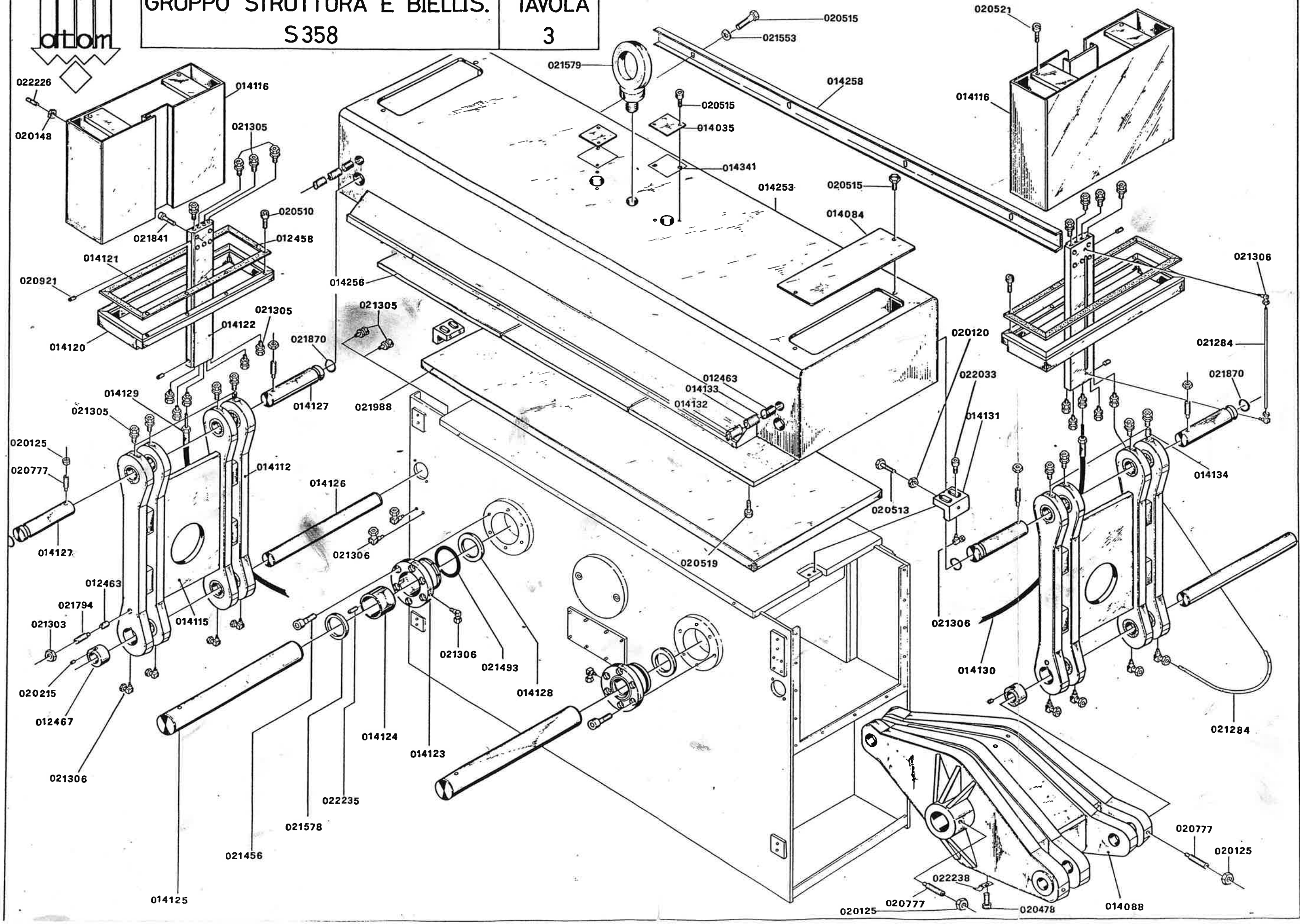

_____ alla matricola _____
_____ data chiusura tavola _____
_____ data apertura tavola _____

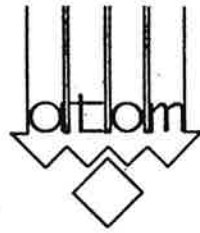

GRUPPO PISTONE
S358

TAVOLA
4

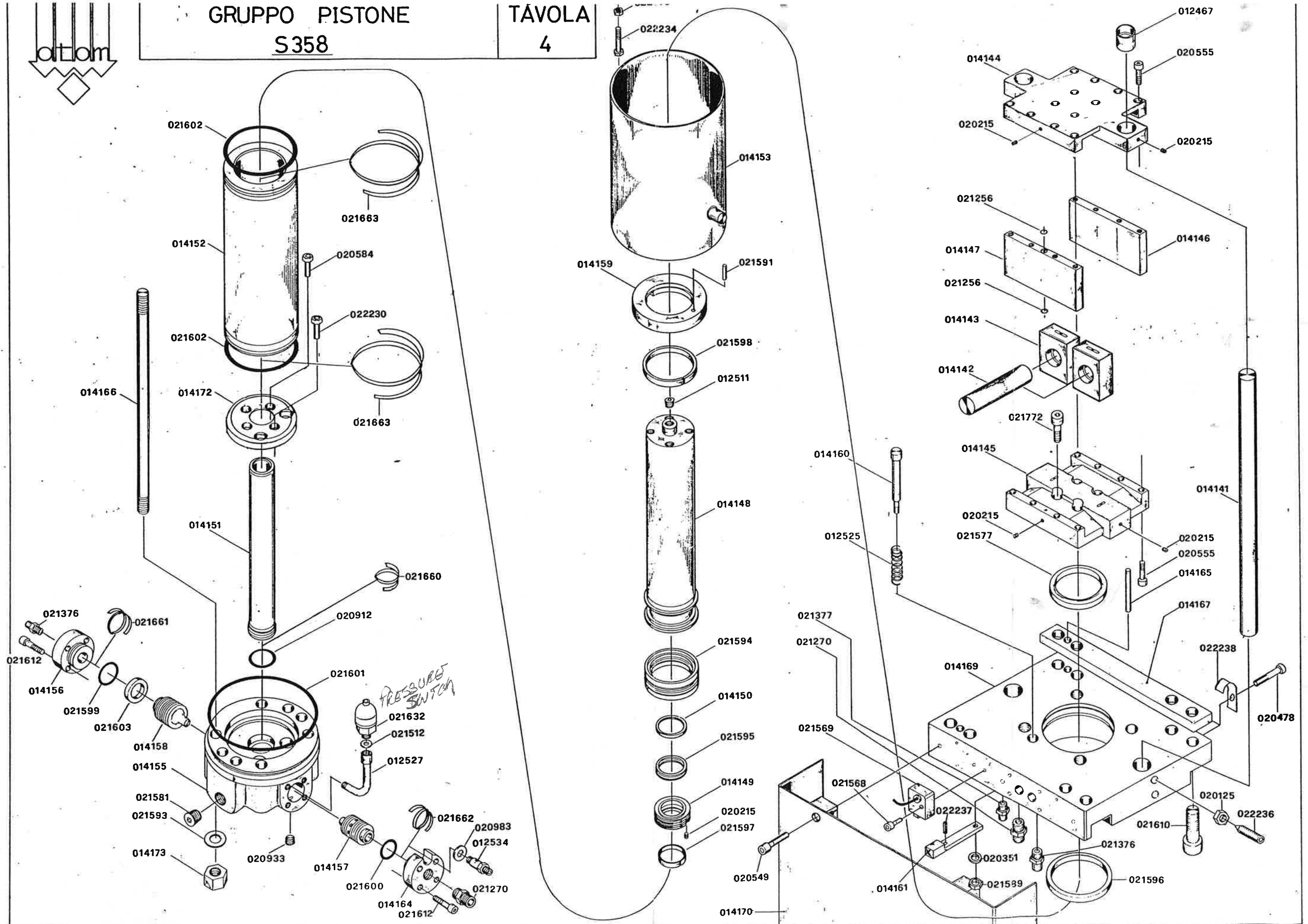

alla matricola _____ alla matricola _____
data apertura tavola _____ data chiusura tavola _____

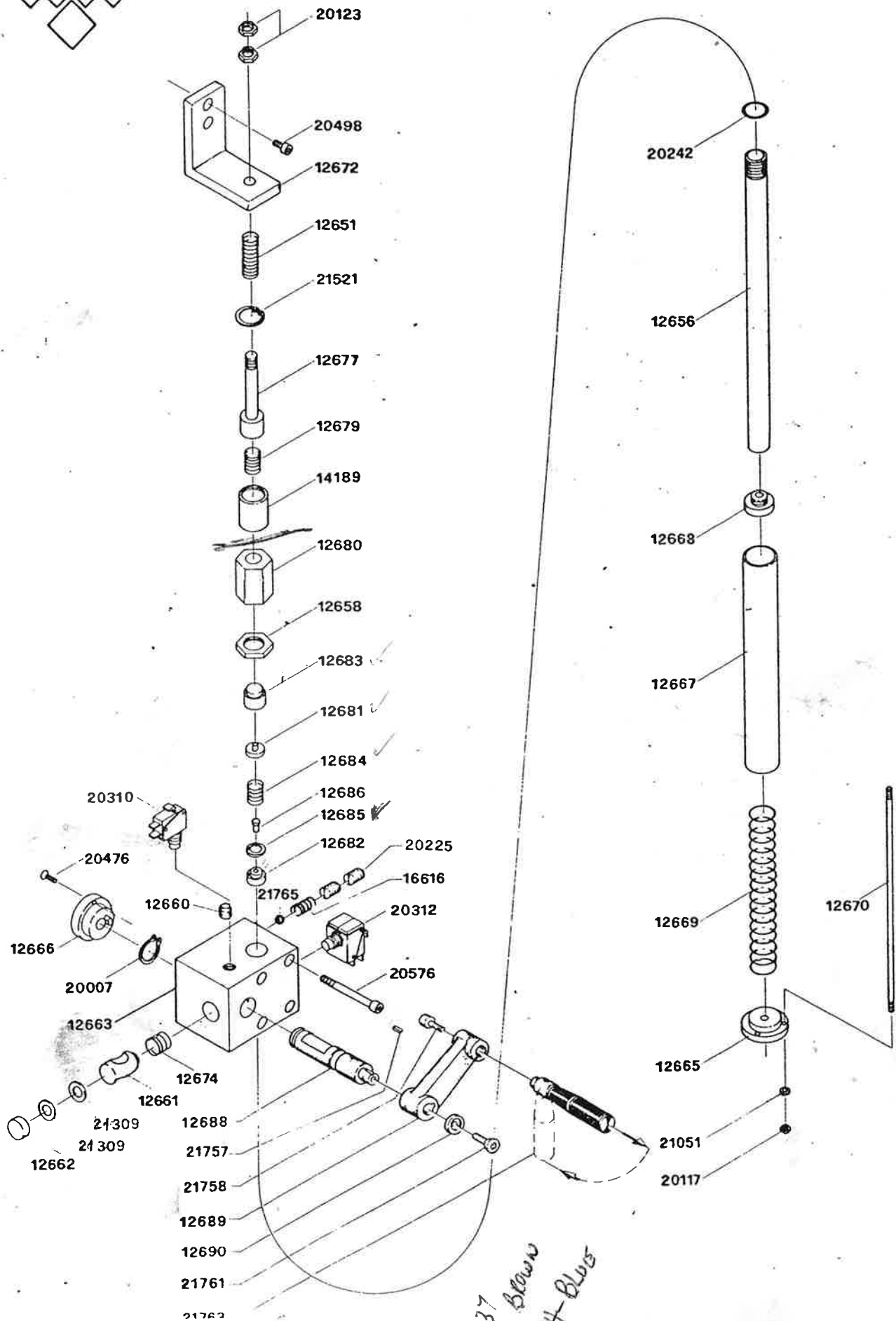

alla matricola _____ alla matricola _____
 ta apertura tavola _____ data chiusura tavola _____

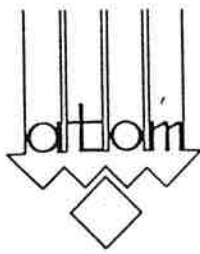

GRUPPO APPARECC. ELETTRICA
S320-S325-S350-S358

TAVOLA
7

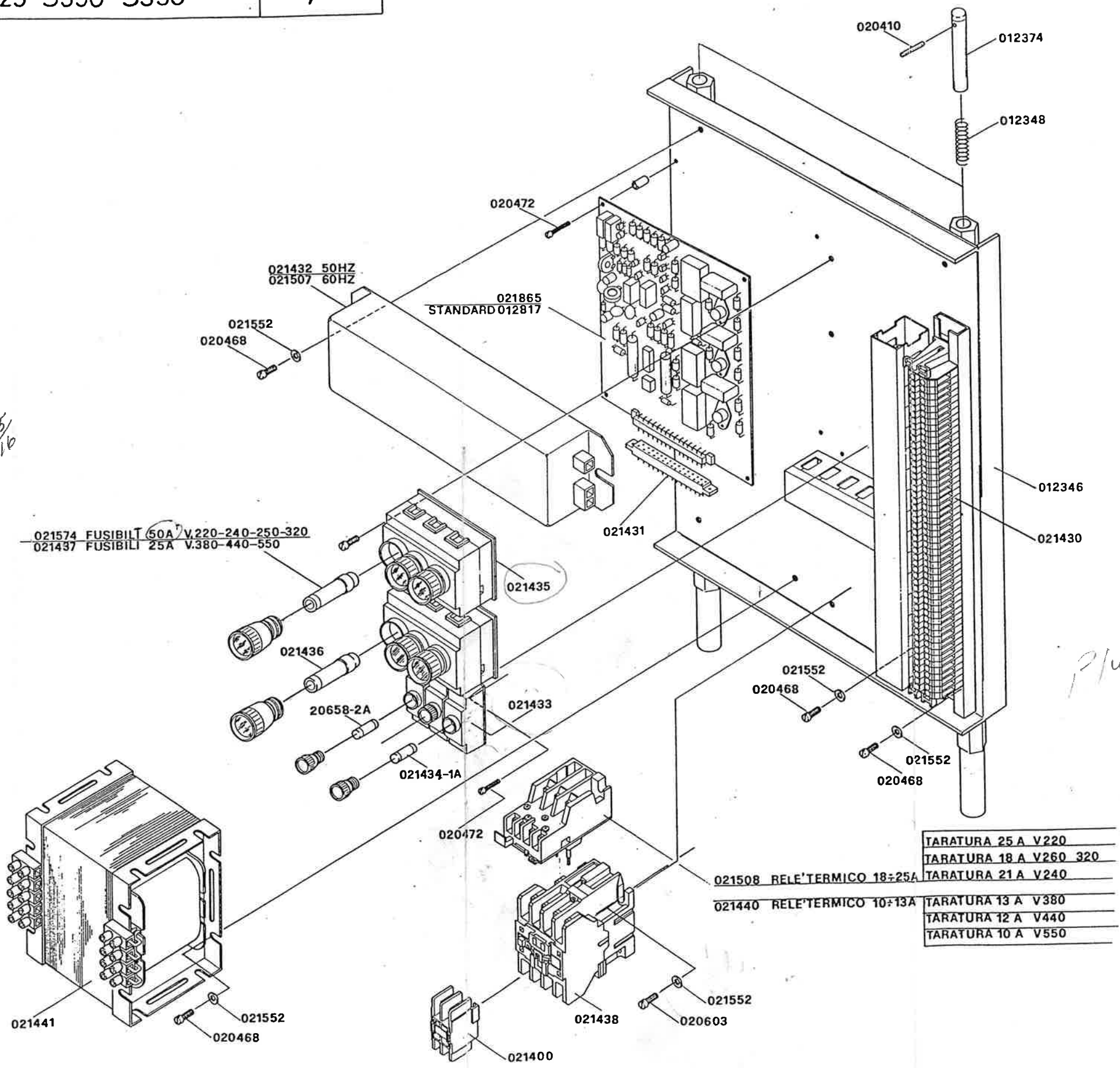

1/15
1/16

P/149

021574 FUSIBILI 50A V.220-240-250-320
021437 FUSIBILI 25A V.380-440-550

021508 RELE' TERMICO 18÷25A	TARATURA 25 A V220
	TARATURA 18 A V260 320
	TARATURA 21 A V240
021440 RELE' TERMICO 10÷13A	TARATURA 13 A V380
	TARATURA 12 A V440
	TARATURA 10 A V550

La matricola _____ alta matricola _____
a. apertura tavola _____ data chiusura tavola _____

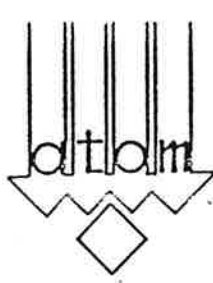

- ① Filtro di aspirazione
- ② Pompa idraulica
- ③ Valvola di strozzamento
- ④ Valvola limitatrice di alta pressione
- ⑤ Distributore di sicurezza 2 posizioni
- ⑥ Distributore di comando 3 posizioni
- ⑦ Valvola limitatrice (tarata 8 BAR)
- ⑧ Valvola di contropressione (tarata 40 BAR)
- ⑨ Valvola di ritegno e di preriempiimento
- ⑩ Cilindro di discesa rapida ponte
- ⑪ Cilindro di taglio
- ⑫ Cilindro di salita ponte
- ⑬ Serbatoio di preriempiimento

- ① FILTRE D'ASPIRATION
- ② POMPE A' ENGREAGES
- ③ SOUPAPE D'ETRANGLEMENT
- ④ SOUPAPE DE PRESSION MAXIMA (TARAGE 200 BAR)
- ⑤ DISTRIBUTEUR DE SECURITE A' 2 POSITIONS
- ⑥ DISTRIBUTEUR DE COMMANDE A' 3 POSITIONS
- ⑦ SOUPAPE DE PRESSION MAXIMA (TARAGE 8 BAR)
- ⑧ SOUPAPE DE CONTRE-BALANCE (TARAGE 40 BAR)
- ⑨ SOUPAPE DE RETENUE ET PREREMPLISSAGE
- ⑩ CYLINDRE DE DESCENTE RAPIDE PONT
- ⑪ CYLINDRE DE DECOUPE
- ⑫ CYLINDRE DE MONTEE PONT
- ⑬ RESERVOIR DE PREREMPLISSAGE

- ① SUCTION FILTER
- ② GEAR PUMP
- ③ THROTTLE VALVE
- ④ PRESSURE RELIEF VALVE
- ⑤ 2-POSITION SAFETY DISTRIBUTOR
- ⑥ 3-POSITION CONTROL DISTRIBUTOR
- ⑦ PRESSURE RELIEF VALVE (SET FOR 8 BARS)
- ⑧ BACK PRESSURE VALVE (SET FOR 40 BARS)
- ⑨ CHECK AND PREFILLING VALVE
- ⑩ BEAM QUICK DOWN STROKE CYLINDER
- ⑪ CUTTING CYLINDER
- ⑫ BEAM UPSTROKE CYLINDER
- ⑬ PREFILLING TANK

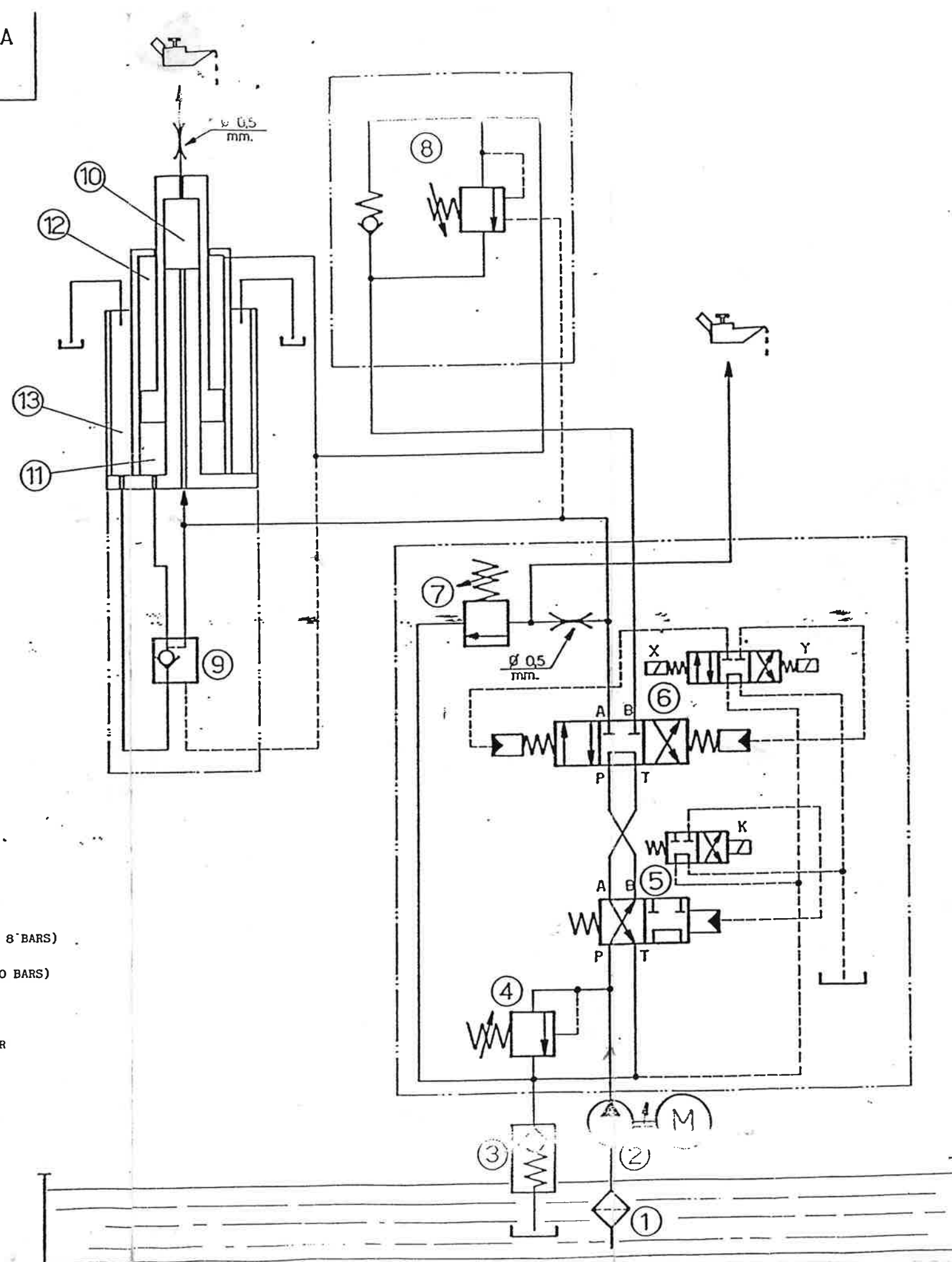

LEGENDA SCHEMA APPARECCHIATURA ELETTRICA S325-S350-S358-S321

1 - INTERRUTTORE GENERALE	(021426)	1 - INTERRUPTEUR	(021426)	1 - MAIN SWITCH	(021426)
2 - FUSIBILI 25A. (VOLT 380/440/550)	(021437)	2 - FUSIBLES 25A. (VOLT 380/440/550)	(021437)	2 - 25A. FUSES (VOLT 380/440/550)	(021437)
FUSIBILI 50A. (VOLT 220/240/250/320)		FUSIBLES 50A. (VOLT 220/240/250/320)		50A. FUSES (VOLT 220/240/250/320)	
3 - CONTATTORE MOTORE POMPA	(021438)	3 - CONTACTEUR MOTEUR POMPE	(021438)	3 - PUMP MOTOR CONTACTOR	(021438)
4 - RELE' TERMICO 10-13A. (021440) 13-18A. (021439) 18-25A. (021508)		4 - RELAIS THERMIQUE 10-13A. (021440) 13-18A. (021439)	(021440)	4 - THERMIC RELAY 10-13A. (021440) 13-18A. (021439)	(021440)
5 - MOTORE POMPA HP.5,5 V.220/50HZ(021288) V.220/60HZ(021289) V.240/50HZ(021290) V.250/60HZ(021291) V.260/50HZ(021292) V.320/60HZ(021293)		5 - MOTEUR POMPE HP.5,5 V.220/50HZ(021288) V.220/60HZ(021289) V.240/50HZ(021290) V.250/60HZ(021291) V.260/50HZ(021292) V.320/60HZ(021293)		5 - PUMP MOTOR HP.5,5 V.220/50HZ(021288) V.220/60HZ(021289) V.240/50HZ(021290) V.250/60HZ(021291) V.260/50HZ(021292) V.320/60HZ(021293)	
6 - FUSIBILI 6A.	(021436)	6 - FUSIBLES 6A.	(021436)	6 - 6A. FUSES	(021436)
7 - PRESA ALIMENTATORE	(021442)	7 - PRISE ALIMENTATEUR	(021442)	7 - MATERIAL FEEDER TAP	(021442)
8 - FUSIBILE 2A.	(020658)	8 - FUSIBLE 2A.	(020658)	8 - 2A. FUSE	(020658)
9 - INTERRUTTORE LAMPADA	(021420)	9 - INTERRUPTEUR LAMPE	(021420)	9 - LAMP SWITCH	(021420)
10 - REATTORE LAMPADA	(021507)	10 - REACTEUR LAMPE	(021507)	10 - LAMP REACTOR	(021507)
11 - LAMPADA	(021354)	11 - LAMPE	(021354)	11 - NEON LAMP	(021354)
12 - TRASFORMATORE 500 VA.	(021441)	12 - TRANSFORMATEUR 500 VA.	(021441)	12 - 500 VA. TRANSFORMER	(021441)
13 - FUSIBILE 2A.	(020658)	13 - FUSIBLE 2A.	(020658)	13 - 2A. FUSE	(020658)
14 - FUSIBILE 1A.	(021434)	14 - FUSIBLE 1A.	(021434)	14 - 1A. FUSE	(021434)
15 - COMMUTATORE AVANZ./ARRETRAMENTO MATERIALE	(021423)	15 - COMMUTATEUR AVANCEMENT ET RECU MATERIEL	(021423)	15 - CHANGE OVER SWITCH FOR FEEDING IN AND BACK OF THE MATERIAL	(021423)
16 - COMANDO A PEDALE	(021357)	16 - INTERRUPTEUR COMMANDE A PEDALE ALIMENTATEUR	(021357)	16 - FEEDER FOOT TREADLE SWITCH	(021357)
17 - COMMUTATORE SALITA-DISCESA RULLI ALIMENTATORE	(021423)	17 - COMMUTATEUR MONTEE-DESCENTE ROULEAUX ALIMENTEUR	(021423)	17 - CHANGE OVER SWITCH FOR UP AND DOWN MOVEMENT OF THE FEEDING ROLLS	(021423)
18 - PULSANTE DI ARRESTO	(021425)	18 - POUSSOIR D'ARRET	(021425)	18 - STOP PUSHBUTTON	(021425)
19 - PULSANTE DI MARCIA	(021424)	19 - POUSSOIR DE MISE EN MARCHE	(021424)	19 - START PUSHBUTTON	(021424)
20 - BOBINA CONTATTORE MOTORE POMPA		20 - BOBINE CONTACTEUR MOTEUR POMPE		20 - PUMP MOTOR CONTACTOR COIL	
21 - SCHEDA COMANDI	(012817)	21 - CIRCUIT IMPRIME DES COMMANDES	(012817)	21 - PRINTED CIRCUIT CARD	(012817)
22 - ELETTRIMAGNETE VALV. SICUREZZA 110/50HZ(022402) 115/60HZ(022403)		22 - ELECTRO-AIMANT SOUPE DE SURETE 110/50HZ(022402) 115/60HZ(022403)		22 - SAFETY VALVE ELECTROMAGNET 110/50HZ(022402) 115/60HZ(022403)	
23 - ELETTRIM. VALV. RISALITA PONTE 110/50HZ(022402) 115/60HZ(022403)		23 - ELECTRO-AIMANT SOUPE DE REMONTEE PONT 110/50HZ(022402) 115/60HZ(022403)		23 - BEAM UPWARD RETURN VALVE 110/50HZ(022402) 115/60HZ(022403)	
24 - MICRO FINE-CORSA RISALITA PONTE (021569)		24 - MICROINTERR. DE FIN-COURSE REMONTEE PONT (021569)		24 - BEAM UPWARD RETURN STROKE-END MICROSWITCH (021569)	
25 - ELETTRIM. VALV. TRANCIATURA 110/50HZ(022402) 115/60HZ(022403)		25 - ELECTRO-AIMANT SOUPE DE DECOUPE 110/50HZ(022402) 115/60HZ(022403)		25 - CUTTING VALVE ELECTROMAGNET 110/50HZ(022402) 115/60HZ(022403)	
26 - CONTATTI AUSILIARI CONTATTORE MOTORE POMPA	(021400)	26 - CONTACTS AUXILIARES CONTACTEUR MOTEUR POMPE	(021400)	26 - PUMP MOTOR CONTACTOR AUX. CONTACTS	(021400)
27 - LAMPADA SPIA ROSSA	(021427)	27 - LAMPE TEMOIN ROUGE	(021427)	27 - RED WARNING LIGHT	(021427)
28 - LAMPADA SPIA VERDE	(021428)	28 - LAMPE TEMOIN VERT	(021428)	28 - GREEN WARNING LIGHT	(021428)
29 - POTENZIOMETRO RISALITA PONTE	(021422)	29 - POTENTIOMETRE REMONTEE PONT	(021422)	29 - BEAM UPWARD RETURN POTENTIOMETER	(021422)
30 - MICRO SU LEVA (U TAV.1) IN POSIZ. 0 (ZERO)	(020312)	30 - MICROINTERR. SUR LE LEVIER (U A LA TABLE 1) EN POSITION 0(ZERO)(020310)		30 - MICROSWITCH LOCATED ON THE LEVER (U PLATE 1) IN 0(ZERO) POSITION	(020312)
31 - POTENZIOMETRO PRESSIONE	(021422)	31 - POTENTIOMETRE PRESSION	(021422)	31 - PRESSURE POTENTIOMETER	(021422)
32 - CONTATTO FINE-CORSA TRANCIATURA	(012686)	32 - CONTACT DE FIN COURSE DECOUPE	(012686)	32 - CUTTING STROKE-END CONTACT	(012686)
33 - PRESSOSTATO FINE-CORSA TRANCIATURA	(021632)	33 - PRESSOSTAT DE FIN COURSE DECOUPE	(021632)	33 - CUTTING STROKE-END PRESSURE SWITCH	(021632)
34 - MICRO SU LEVA (U TAV.1) IN POSIZ. 1-0-2	(020310)	34 - MICROINTERR. SUR LE LEVIER (U A LA TABLE 1) EN POSITION 1-2		34 - MICROSWITCH LOCATED ON THE LEVER (U PLATE 1) IN 1 OR 2 POSITION	(020310)
37 - BARRIERA FOTOELETTRICA ANTINFORTUNISTICA	(021356)	37 - BARRIERE PHOTOELECTRIQUE	(021356)	37 - PHOTOCELLS SAFETY-BARRIER	(021356)
38 - SPINA PER BARRIERA FOTOELETTRICA ANTINFORTUNISTICA	(012805)	38 - FICHE DE CONNEXION BARRIER PHOTOELECTRIQUE	(012805)	38 - PHOTOCELLS SAFETY-BARRIER PLUG	(012805)
39 - SCHEDINA CONTROLLO CONTAINPULSI	(021645)	39 - CIRCUIT IMPRIME POUR COMPTE-COUPS	(021645)	39 - CUT-COUNTING DEVICE CARD	(021645)
40 - CONTAINPULSI	(021012)	40 - COMPTE-COUPS A PROGRAMMER	(021012)	40 - CUT-COUNTING DEVICE	(021012)
41 - LED SEGNAZIONE FINE-CONTEGGIO	(022274)	41 - LED SIGNALISATION A PROGRAMMER	(022274)	41 - COUNTING END LED	(022274)
42 - INTERRUTTORE CONTAINPULSI	(021421)	42 - INTERRUPTEUR D'INSERTION COMPTE-COUPS	(021421)	42 - CUT-COUNTING DEVICE SWITCH	(021421)
43 - SENSIBILI DI COMANDO (014054-014055)		43 - CONTACTS SENSIBLES DE COMMANDE (014054-014055)		43 - HAND CONTACT CONTROLS (014054-014055)	
44 - DISPOSITIVO AVVIAMENTO Y/ PER COLLEGAMENTO V.220 (030405)		44 - DISPOSITIF DE DEMARRAGE Y/ POUR BRANCHEMENT A 220V. SEULEMENT (030405)		44 - Y/ SPECIAL STARTING DEVICE FOR 220V. CONNECTION (030405)	

02001965

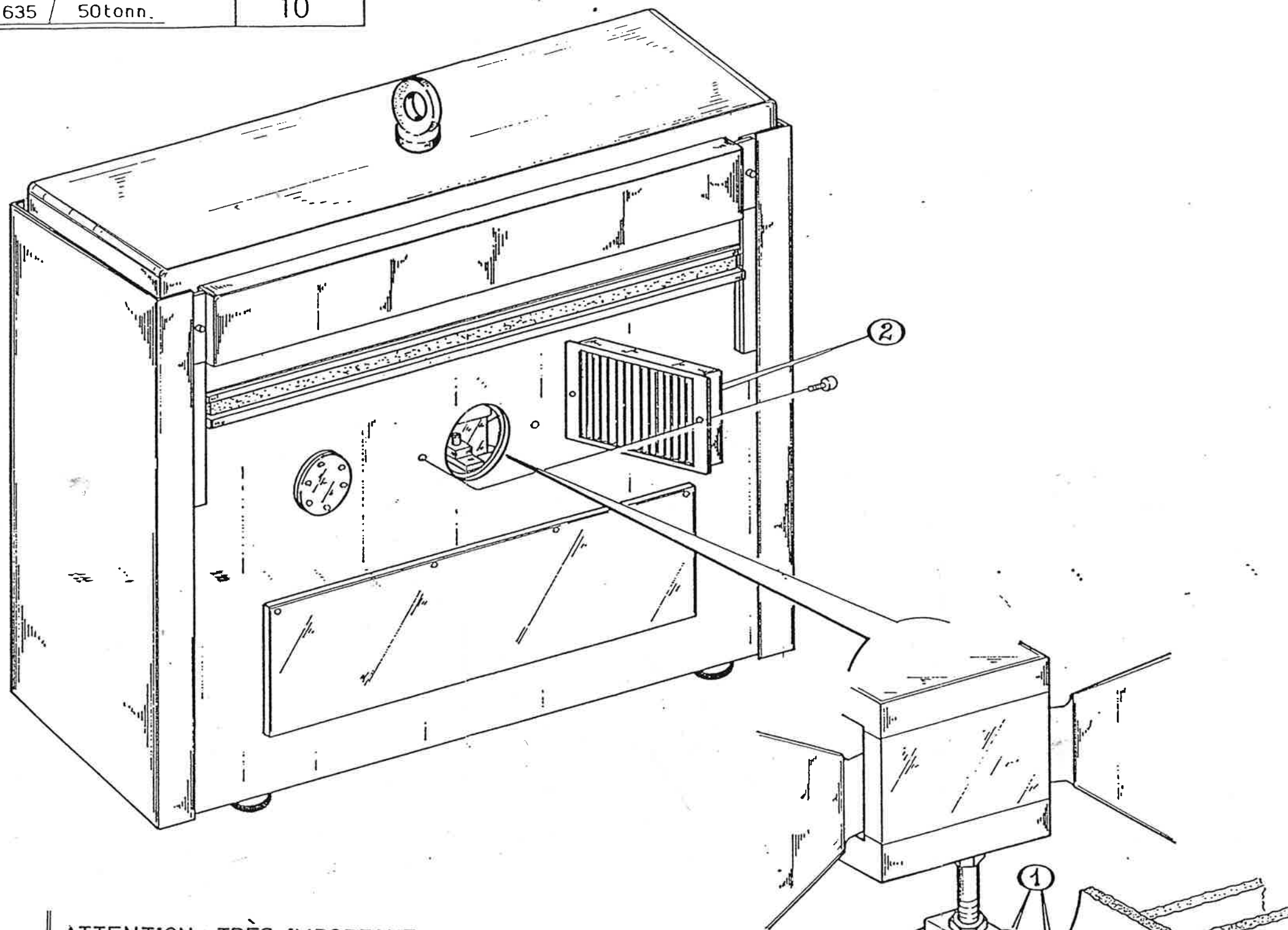

ATTENZIONE : MOLTO IMPORTANTE

All'atto dell'installazione della macchina togliere il filtro posteriore (2) le viti (1) e rimuovere la staffa di vincolo ponte

ATTENTION:IT IS VERY IMPORTANT

Before connecting up the machine you must remove the back filter (2) and screws (1) as well as the beam constraint bracket

ATTENTION : TRÈS IMPORTANT

Avant de brancher la machine enlever le filtre postérieur (2) les vis (1) et ôter l'étrier d'arrêt pont.

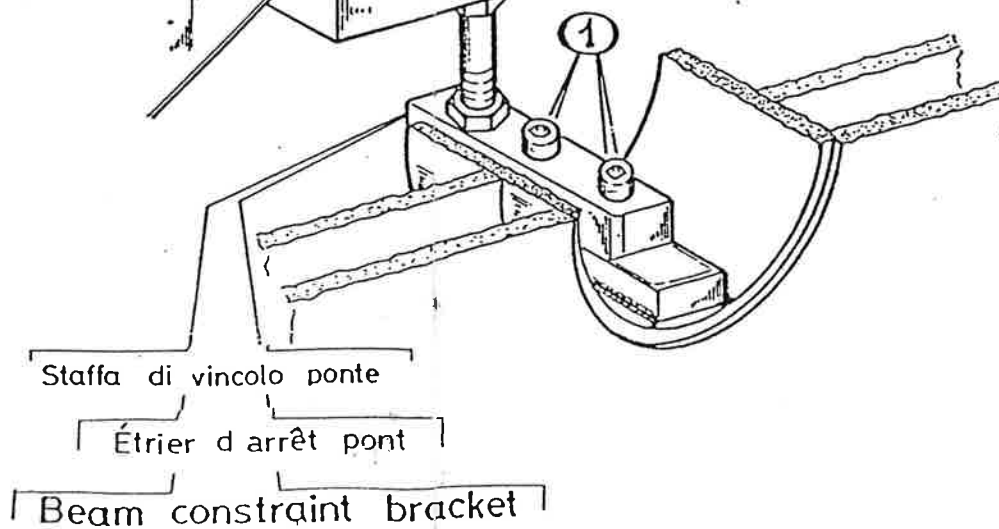

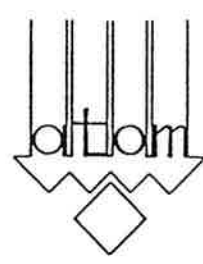

GRUPPO ALIMENTATORE AUTOM. TAVOLA
AL 81 (1600x120)
11

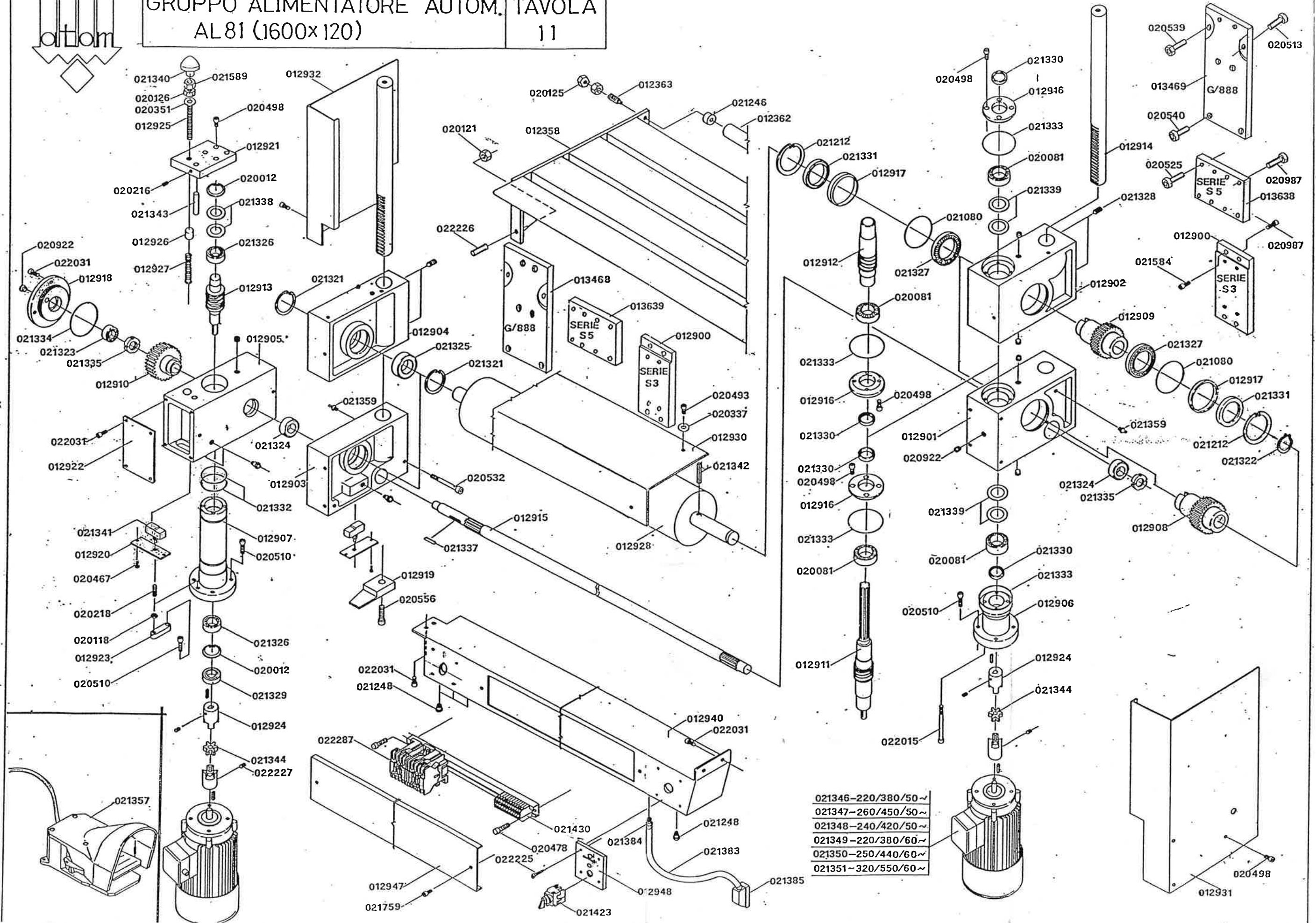

alla matricola _____ alla matricola _____
data apertura tavola _____ data chiusura tavola _____

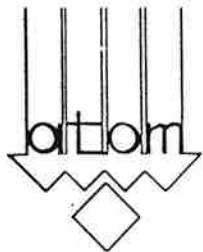

GRUPPO AVVIATORE



S320 S325 S350 S358

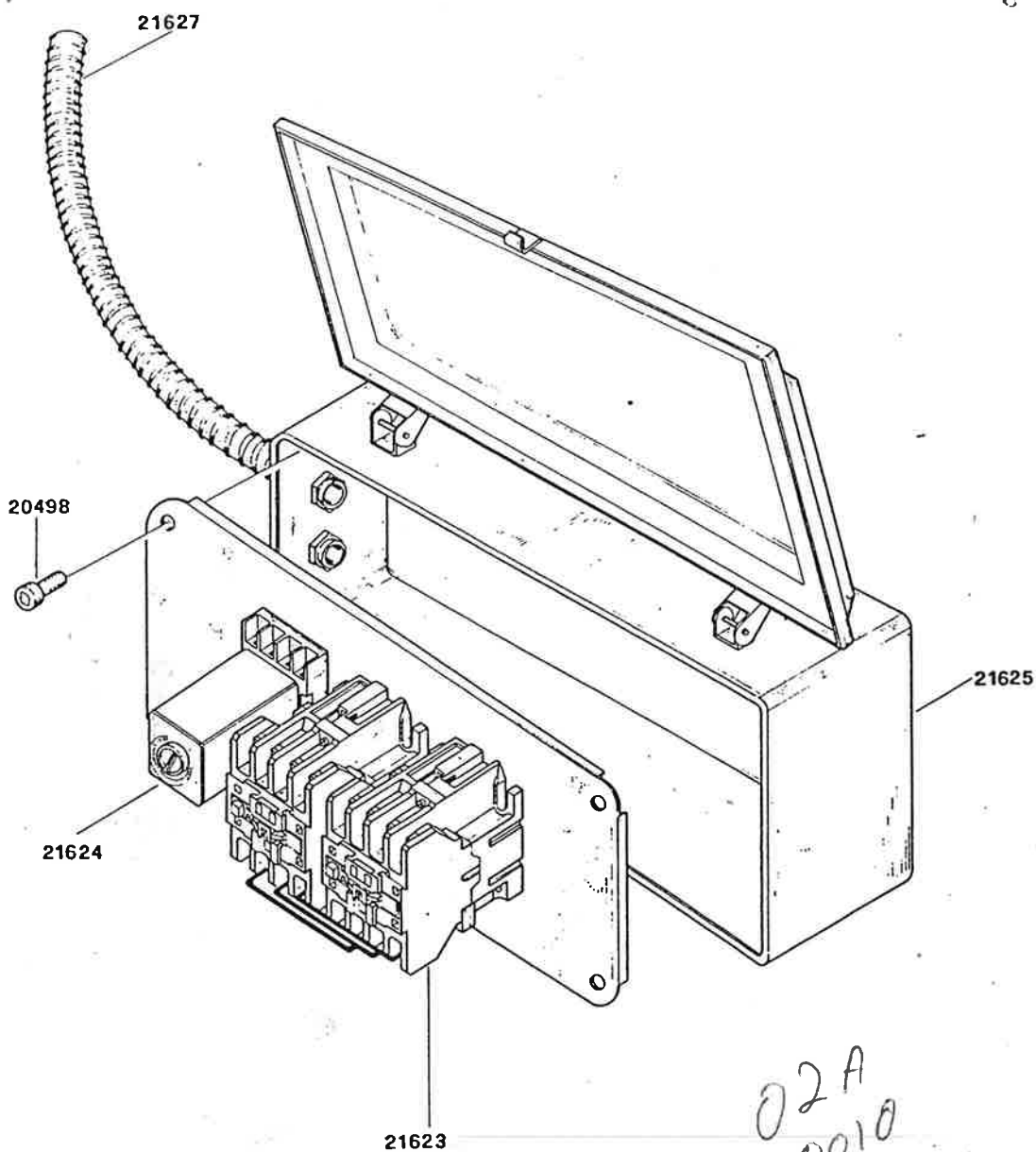

matricola _____ alla matricola _____
apertura tavola _____ data chiusura tavola _____

02A
0010



TAVOLO POSTERIORE S358

TAVOLA
12

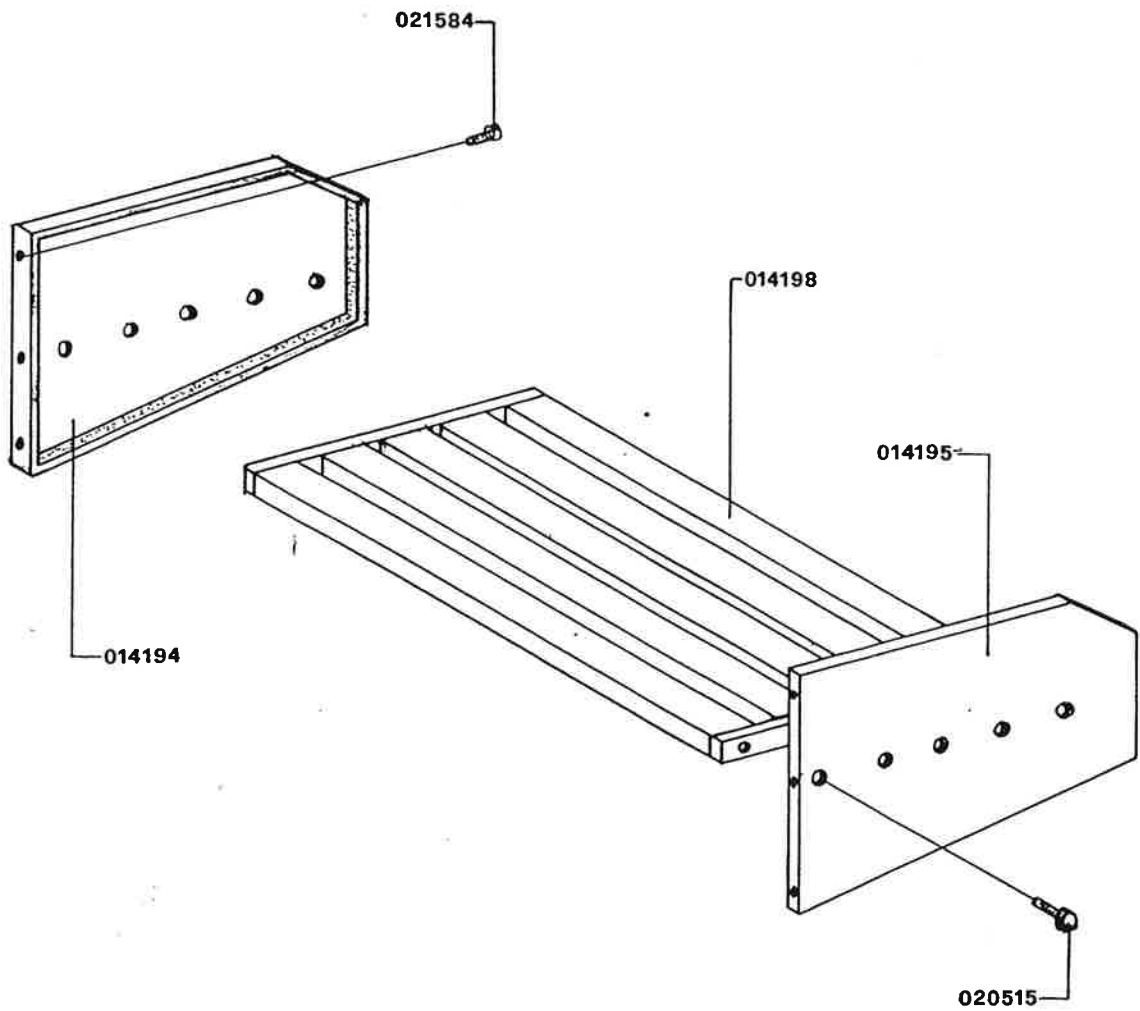

a matricola _____ alla matricola _____
l'apertura tavola _____ data chiusura tavola _____

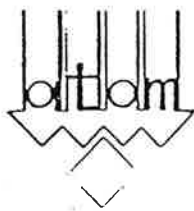

SCHEMA ATTARECC. ELETTRICA
AL 81-82-83

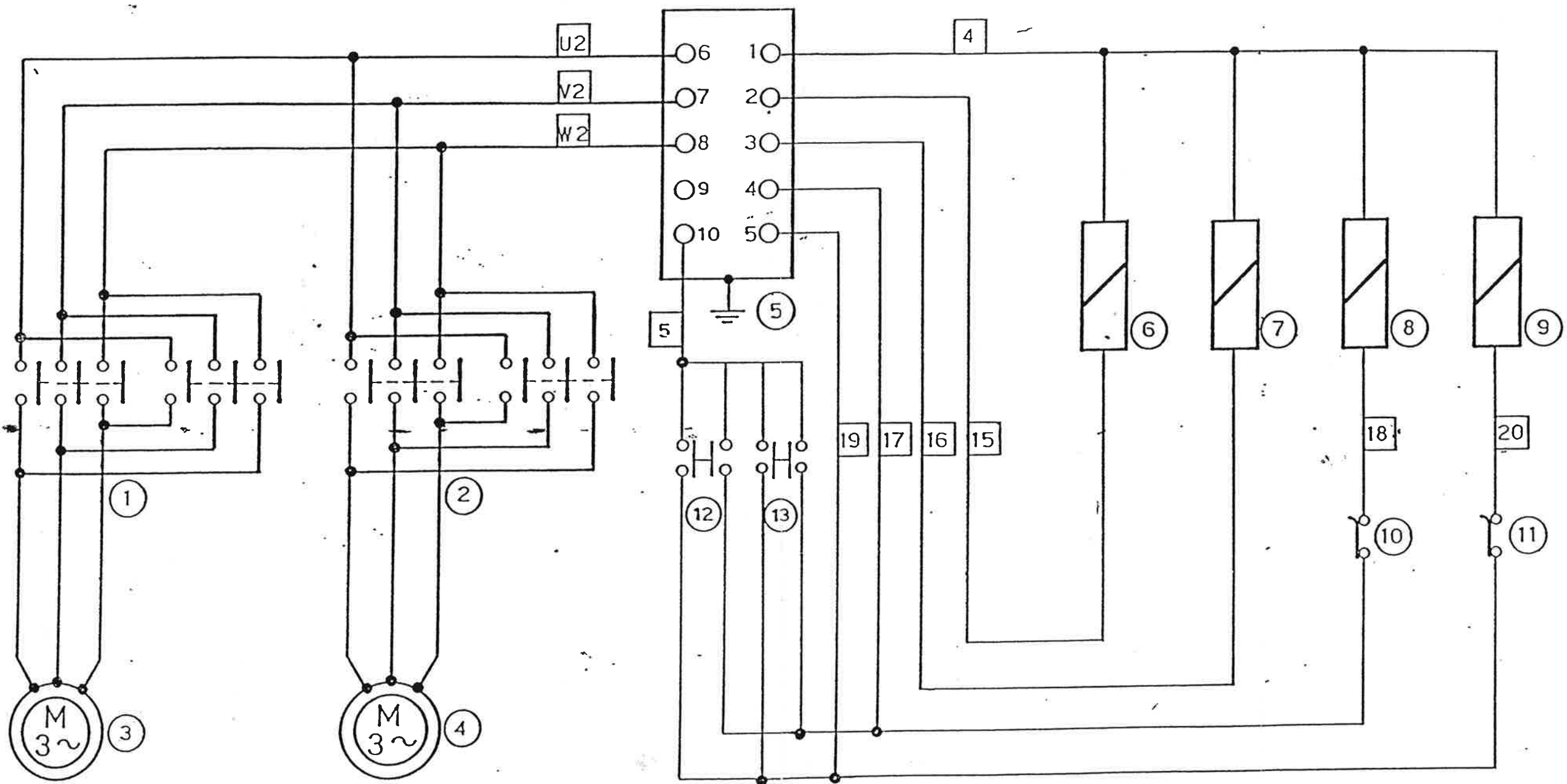

- 1 - TELEINVERTITORE AVANTI-INDIETRO MATERIALE
- 2 - TELEINVERTITORE SALITA-DISCESA MATERIALE
- 3 - MOTORE AVANTI-INDIETRO MATERIALE
- 4 - MOTORE SALITA-DISCESA MATERIALE
- 5 - SPINA ALIMENTATORE
- 6 - BOBINA TELEINVERTITORE INDIETRO
- 7 - BOBINA TELEINVERTITORE AVANTI
- 8 - BOBINA TELEINVERTITORE SALITA
- 9 - BOBINA TELEINVERTITORE DISCESA
- 10- FINE-CORSA SALITA
- 11- FINE-CORSA DISCESA
- 12- INTERRUPTORE DI APERTURA E CHIUSURA RULLI
- 13- INTERRUPTORE DI APERTURA E CHIUSURA RULLI

- 1 - REMOTE CONTROL REVERSER FOR FEEDING IN AND BACK OF THE MATERIAL
- 2 - REMOTE CONTROL REVERSER FOR UP AND DOWN MOVEMENT OF THE FEED ROLLS
- 3 - MOTOR FOR FEEDING IN AND BACK OF THE MATERIAL
- 4 - MOTOR FOR UP AND DOWN MOVEMENT OF THE FEED ROLLS
- 5 - AUTOMATIC FEEDER PIN
- 6 - REMOTE CONTROL REVERSER COIL FOR FEEDING BACK OF THE MATERIAL
- 7 - REMOTE CONTROL REVERSER COIL FOR FEEDING IN OF THE MATERIAL
- 8 - REMOTE CONTROL REVERSER COIL FOR UP MOVEMENT OF THE FEED ROLLS
- 9 - REMOTE CONTROL REVERSER COIL FOR DOWN MOVEMENT OF THE FEED ROLLS
- 10- STROKE-END OF UP MOVEMENT OF THE FEED ROLLS
- 11- STROKE-END DOWN MOVEMENT OF THE FEED ROLLS
- 12- ROLLS OPENING/CLOSING SWITCH
- 13- ROLLS OPENING/CLOSING SWITCH

- 1 - TELEINVERSEUR AVANCEMENT-RECUJ MATERIALE
- 2 - TELEINVERSEUR MONTEE-DESCENTE ROULEAUX
- 3 - MOTEUR AVANCEMENT-RECUJ MATERIALE
- 4 - MOTEUR MONTEE-DESCENTE ROULEAUX
- 5 - FICHE ALIMENTATEUR
- 6 - BOBINE TELEINVERSEUR RECUJ
- 7 - BOBINE TELEINVERSEUR AVANCEMENT
- 8 - BOBINE TELEINVERSEUR MONTEE
- 9 - BOBINE TELEINVERSEUR DESCENTE
- 10- FIN COURSE MONTEE
- 11- FIN COURSE MONTEE
- 12- INTERRUPTEUR POUR OUVERTURE ET FERMETURE ROULEAUX
- 13- INTERRUPTEUR POUR OUVERTURE ET FERMETURE ROULEAUX

alla matricola _____
data chiusura tavola _____
Data matricola _____
Data apertura tavola _____

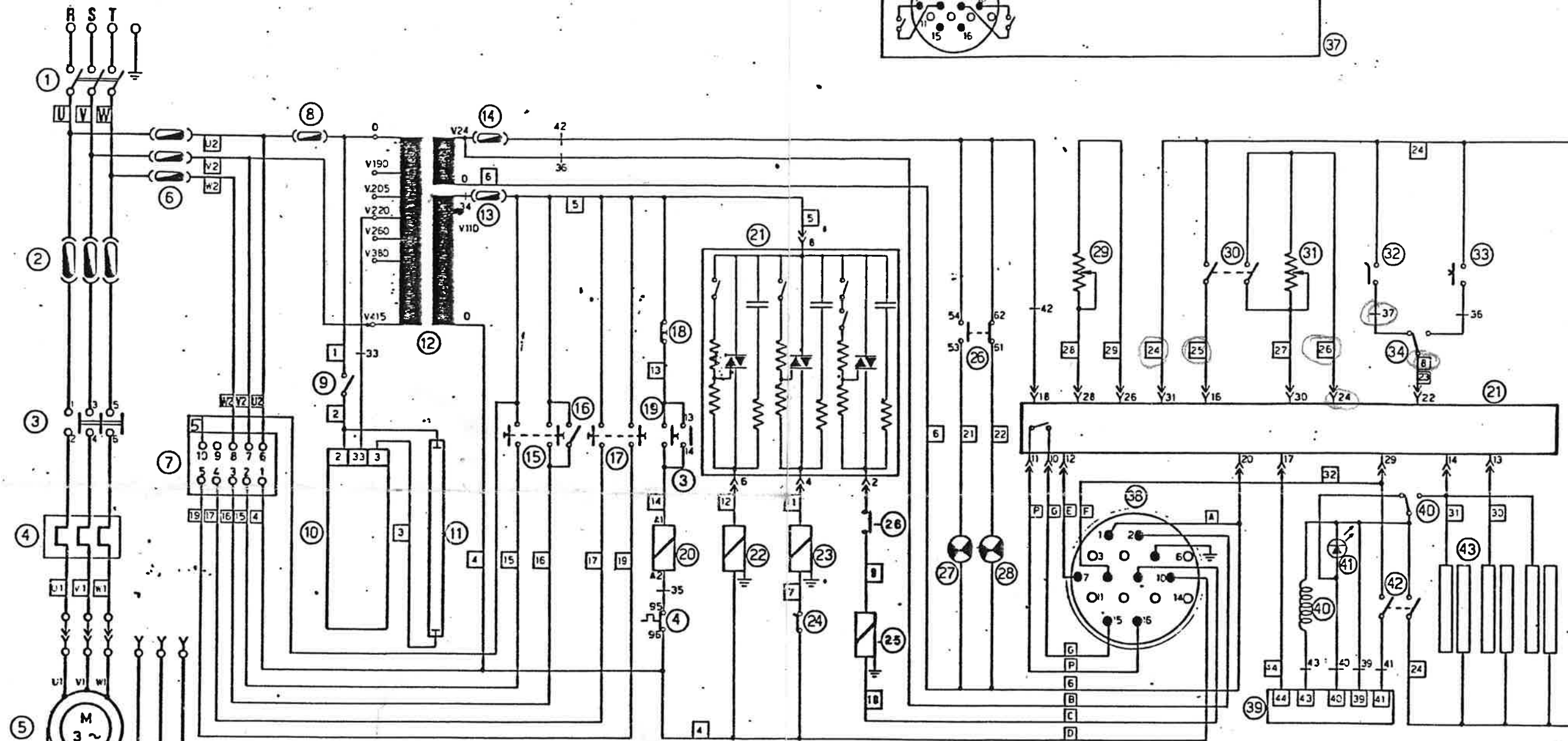
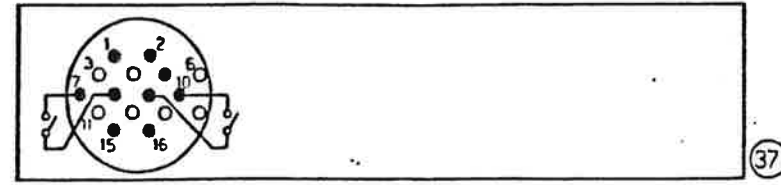

Dalla matricola alla matricola
Data apertura tavola data chiusura tavola

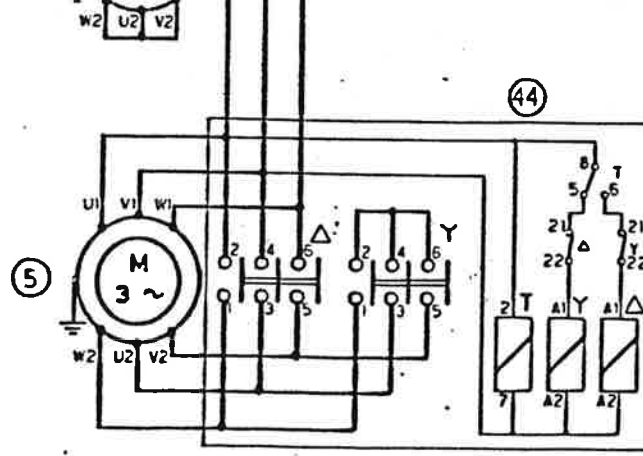

- | | | |
|--|---|--|
| 1-INTERRUTTORE GENERALE (21426) | 16-COMANDO A PEDALE (21357) | 31-POTENZIOMETRO PRESSIONE (21422) |
| 2-FUSIBILI 25A. (VOLT 380/440/550) (21437) | 17-COMMUTATORE SALITA-DISCESA RULLI ALIMENTATORE (21423) | 32-CONTATTO FINE-CORSA TRANCIATURA (12686) |
| FUSIBILI 50A. (VOLT 220/240/250/320) (21506) | 18-PULSANTE DI ARRESTO (21425) | 33-PRESSOSTATO FINE-CORSA TRANCIATURA (21632) |
| 3-CONTATTORE MOTORE POMPA (21438) | 19-PULSANTE DI MARCIA (21424) | 34-MICRO SU LEVA(U TAV.1) IN POSIZ 1-0-2 (20310) |
| 4-RELE' TERMICO 10-13A (21440) 13-18A (21439) 18-25A (21508) | 20-BOBINA CONTATTORE MOTORE POMPA/ (21400) | 37-BARRIERA FOTOELETTRICA ANTINFORTUN. (21356) |
| 5-MOTORE POMPA HP5,5 V.220/60HZ(21289) V.240/50HZ(21290) V.260/50HZ(21292) V.320/60HZ(21293) | 21-SCHEDA COMANDI (12817) | 38-SPINA PER BARRIERA FOTOELETTR. ANTIN. (12805) |
| 6-FUSIBILI 6A. (21436) | 22-ELETTROMAGNETE VALV. SICUREZZA 110/50HZ(21652) 115/60HZ(21653) | 39-SCHEDINA CONTROLLO CONTAIMPULSI (21645) |
| 7-PRESA ALIMENTATORE (21442) | 23-ELETTROMAGNETE VALV. RISALITA PONTE 110/50HZ (21652) 115/60HZ(21653) | 40-CONTAIMPULSI (21012) |
| 8-FUSIBILE 2A. (20658) | 24-MICRO FINE-CORSA RISALITA PONTE (21569) | 41-LED SEGNAZIONE FINE-CONTEGGIO (21429) |
| 9-INTERRUTTORE LAMPADA (21420) | 25-ELETTROM. VALVOLA TRANCIATURA 110/50HZ(21652) 115/60HZ(21653) | 42-INTERRUTTORE CONTAIMPULSI (21421) |
| 10-REATTTORE LAMPADA 50HZ(21432)60HZ(21507) | 26-CONTATTI AUSILIARI CONTATTORE MOTORE(21400) POMPA | 43-SENSIBILI DI COMANDO (14054-14055) |
| 11-LAMPADA (21354) | 27-LAMPADA SPIA ROSSA (21427) | 44-DISPOSITIVO AVVIAMENTO Y/Δ PER COLLEGAMENTO V.220 (30405) |
| 12-TRASFORMATORE 500VA. (21441) | 28-LAMPADA SPIA VERDE (21428) | |
| 13-FUSIBILE 2A. (20658) | 29-POTENZIOMETRO RISALITA PONTE (21422) | |
| 14-FUSIBILE 1A. (21434) | 30-MICRO SU LEVA (U TAV.1) IN POSIZ.0(ZERO)(20312) | |
| 15-COMMUTATORE AVANZ./ARRETR.MATERIALE (21423) | | |